

**NOVA  
DVR 3000™  
WOODLATHE**



Publication No.101-0505-006

Last updated 17 November 03

**Models**

**55016 spindle thread 1 1/4" x 8 tpi 115v  
55077 spindle thread M33x3.5 220-240v  
55078 spindle thread 1 1/4" x 8 tpi 220-240v  
Software Version 4.1**

# Nova DVR 3000 Lathe Features at a glance

## DVR Electronic drive

The Nova DVR 3000 lathe is unique. The DVR incorporates the motor built as part of the headstock, the spindle and motor are one unit. The motor is almost maintenance free and designed with high reliability. The Digital Variable Reluctance motor uses smart motor technology to provide an incredibly smooth and powerful drive. The drive takes turning to a new level. The controller monitors the spindle position constantly and maintains spindle speed very closely. Additional power is added as it senses extra load from the tool.

## Add on Bed System

A lathe that meets your woodturning needs your workshop space, and your pocket! Each segment is 20" or 510mm in length. The feature appeals for many different reasons:

As a compact lathe (standard configuration) it is great for small turning workshop spaces.

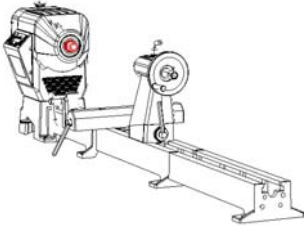

As an extended lathe for those wanting to do extra long spindles (beyond the traditional between center of most lathes) the Nova 3000 delivers big turning capacity. Illustrated at left.

As a bowl lathe for those just wanting to turn bowls.

## Sophisticated Swivel Head

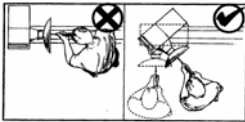

Swivel head lathes have many advantages:

- Space saving
- Allows the turner (not the machine!) to decide the most comfortable position for your turning (saving you from backstrain)
- Elimination of left-hand 'outboard' turning techniques and no extra outboard chucks and faceplates are necessary.

There are a number of swivel head lathes available, but the Nova DVR 3000 has by far the most sophisticated, accurate and easy to use swivel head on the market.

The Nova DVR 3000 lathe can be easily and quickly swiveled to any position (360 degrees). It can be solidly locked in any position plus it has the added security of a detent pin lock at 0,22.5,45,90 degrees plus 315 (for left-hand use).

The swivel head turns, locks easily and has a very accurate detent position, to lock the spindle in line with the tailstock. The combination of rigid Tailstock construction and detent pin delivers superb accuracy and is unique to the Nova DVR 3000.

## Solid Construction

Well proven design, the Nova DVR 3000 is made from Cast Iron components for strength and rigidity. Added features like the heavy duty TRIMAX triple bearing system, and special webbed bed design makes the lathe well equipped to take heavy turning stresses. The bed has been designed with vibration dampening qualities - a solid 1/2" cross rib is positioned along the bed unit, quickly dissipating any vibration as it travels down the bed.

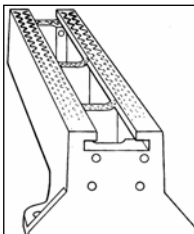

Cast-iron has always been the material of choice for Woodlathe construction for its inherent mass and an excellent modulus of vibration.

# Welcome

Thank you for choosing our Nova DVR 3000 Woodlathe and welcome to the Teknatool product family. Your choice shows you want the best for your woodturning and you recognise the superb DVR drive technology and the host of other unique features the Nova DVR 3000 offers.

We strive to achieve the best value for your money – providing quality, innovative features, a wide range of accessories (some like our Ornamental Turner are unique to Teknatool) – plus comprehensive, ongoing support (latest manuals downloadable from our website, newsletters, projects etc). We are only a phone call or email away with technical advice or assistance on the operation of your lathe or your woodturning queries.

Please feel free to contact us about any aspect of our products or service – we regard our customers as our best development and improvement team – we would love to hear from you!

Once again, welcome to the “Teknatool Family”. We trust that you enjoy our products and hope they enhance the pleasure you experience from the wonderful craft of woodturning!

Best Regards

Brian Latimer  
Marketing Director  
Teknatool International Ltd

# Contact Teknatool

 Teknatool International Ltd  
P.O.Box 180034 Luckens Point  
Henderson, Auckland 1008  
New Zealand

 Phone: (+64) 9 837 6900

 Fax: (+64) 9 837 6901

Email: [service@teknatool.com](mailto:service@teknatool.com)  
Website: [www.teknatool.com](http://www.teknatool.com)

## United States

### Teknatool International

Free Phone: 1-866-748-3025  
Free Fax: 1-866-748-4193  
Email: [service@teknatool.com](mailto:service@teknatool.com)  
Website: [www.teknatool.com](http://www.teknatool.com)

### Woodcraft Supply Corp

Technical Service: 1-800-535-4486  
Orders: 1-800-225-1153  
Website: [www.woodcraft.com](http://www.woodcraft.com)  
Contact them for a copy of their catalogue, or for a list of their stores throughout the USA.

## Australia

### Teknatool International

Free Phone: 1-800-140-761  
Free Fax: 1-800-140-755  
Email: [service@teknatool.com](mailto:service@teknatool.com)  
Website: [www.teknatool.com](http://www.teknatool.com)  
Contact us for a free catalogue and a list of stores throughout Australia.

## Canada

### KMS Tools and Equipment Ltd

Phone: (+1) 604-522-5599  
Free Phone: 1-800-567-8979  
Fax: (+1) 604-522-0638  
Email: [kmstools@kmstools.com](mailto:kmstools@kmstools.com)  
Website: [www.kmstools.com](http://www.kmstools.com)

## United Kingdom

### Robert Sorby

Phone: (+44) 114 225 0700  
Fax: (+44) 114 225 0710  
Email: [sales@robert-sorby.co.uk](mailto:sales@robert-sorby.co.uk)  
Website: [www.robert-sorby.co.uk](http://www.robert-sorby.co.uk)

## France

### Philbois Machines & Outils Pour Le Bois

Phone: (+33) 4-94-68- 82-32  
Fax: (+33) 4-94-68-81-89  
Email: [philbois@wanadoo.fr](mailto:philbois@wanadoo.fr)

## Iceland

### Gylfi Sigurlinnason

Phone: (+354) 555-1212  
Fax: (+354) 555-2652  
Email: [haki@centrum.is](mailto:haki@centrum.is)

## Norway

### WWW VERKTOY AS

Phone: (+47) 51-88-6800  
Fax: (+47) 51-88-6810  
Email: [tredreie@ogreid.no](mailto:tredreie@ogreid.no)  
Website: [www.verktoyas.no](http://www.verktoyas.no)

## Japan

### Ikeda Inc

Phone: (+81) 555-726-860  
Fax: (+81) 555-726-865  
Email: [fine@ikedatools.co.jp](mailto:fine@ikedatools.co.jp)

## South Africa

### The Hardware Centre

Phone: (27) 011 791 0844  
Fax: (27) 011 791 0850

This is the list of Countries/Resellers that currently stock and sell the Nova 3000 Woodlathe. In addition, Teknatool sells a more limited range into many other countries. Contact us for details, or see our website.

## **Table of Contents**

General safety rules .....	6
Additional safety rules for woodlathes .....	7
DVR 3000 Woodlathe Specifications .....	8
Workshop Requirements .....	9
Lathe Stand Recommendations .....	9
Example of Shop-made Lathe Stand .....	10
Assembling the Nova DVR 3000 .....	11
Nova DVR 3000 Components After Unpacking .....	11
Installing the Headstock Lockpin .....	11
Adding an Extension Bed .....	12
Mounting the Lathe to a Support Surface .....	13
Connecting to Power .....	13
Using the Nova DVR 3000 .....	14
DVR Drive Functions .....	15
Turning Tips .....	17
Swiveling the Headstock .....	18
Spindle Index .....	18
Headstock .....	19
Spindle Thread Size .....	19
Toolrest .....	20
Tailstock .....	22
Learning Turning .....	22
Maintaining the Nova DVR3000 .....	23
General Maintenance .....	23
Cleaning the Toolslide .....	23
Cleaning the Tailstock .....	24
Troubleshooting Guide .....	24
Troubleshooting Guide continued .....	26
DVR 3000 Woodlathe Parts List .....	27
Accessories .....	29
Accessories .....	32
Index .....	33

---

© Copyright 2001 by Teknatool International; All Rights Reserved.  
Nova DVR 3000 is a trademark of Teknatool International Ltd.

The information and specifications contained herein are subject to change. Teknatool is not responsible for errors or omissions herein or for incidental damages in connection with the furnishing or use of this information.

# GENERAL SAFETY RULES



**Warning!** Failure to follow these rules may result in serious personal injury.

- FOR YOUR OWN SAFETY, READ THE MANUAL BEFORE OPERATING THE TOOL.** Learn the machine's application and limitations plus the specific hazards peculiar to it.
- ALWAYS USE A FULL FACE SHIELD- Strongly recommended** (must comply with ANSI STANDARD Z87.1 -USA) Everyday eye-glasses usually are only impact resistant and safety glasses only protect eyes. A full face shield fill protect the eyes and face. Also use face or dust mask if cutting operation is dusty.
- WEAR PROPER APPAREL.** Do not wear loose clothing, gloves, neckties, rings, bracelets or other jewelry which may get caught in moving parts. Non slip footwear is recommended. Wear protective hair covering to contain long hair.
- USE EAR PROTECTORS.** Use ear muffs for extended period of operation. Use muffs rated to 103 DBA LEQ (8 hour).
- DON'T USE IN DANGEROUS ENVIRONMENT.** Don't use power tools in damp or wet locations, or expose them to rain. Keep work area well lit.
- KEEP WORK AREA CLEAN.** Cluttered areas and benches invite accidents. Build up of sawdust is a fire hazard.
- KEEP CHILDREN AND VISITORS AWAY.** The Nova DVR 3000 is **not recommended** for children and infirm. Such personnel and onlookers should be kept a safe distance from work area.
- MAKE WORKSHOP CHILDPROOF** with locks, master switches, or by removing starter keys.
- GROUND ALL TOOLS.** If the tool is equipped with a three prong plug, it should be plugged into a three hole electrical receptacle. If an adapter is used to accommodate a two prong receptacle, the adapter lug must be attached to a known ground. Never remove the third prong.
- MAKE SURE TOOL IS DISCONNECTED FROM POWER SUPPLY** while the motor is being mounted, connected, or reconnected.
- DISCONNECT TOOLS from wall socket** before servicing and when changing accessories such as blades, bits, cutters and fuses etc.
- AVOID ACCIDENTAL STARTING.** Make sure switch is in the Off position before plugging in power cord.
- NEVER LEAVE MACHINE RUNNING UNATTENDED.** Do not leave machine unless it is turned off and has come to a complete stop.
- KEEP GUARDS IN PLACE** and in working order.
- USE RIGHT TOOL.** Do not use a tool or attachment to do a job for which it was not designed.
- USE RECOMMENDED ACCESSORIES.** The use of improper accessories may cause hazards.
- DON'T FORCE TOOL.** It will do the job better and be safer at the rate for which it was designed.
- MAINTAIN TOOLS IN TOP CONDITION.** Keep tools sharp and clean for best and safest performance. Follow instructions for lubricating and changing accessories.
- NEVER STAND ON TOOL.** Serious injury could occur if the tool is tipped or if the cutting tool is accidentally contacted.
- REMOVE ADJUSTING KEYS AND WRENCHES.** Form a habit of checking to see that keys and adjusting wrenches are removed from tool before turning it on.
- DON'T OVERREACH.** Keep proper footing and balance at all times.
- DIRECTION OF FEED.** Feed work into a blade or cutter against the direction of rotation of the blade or cutter only.
- ATTENTION TO WORK.** Concentrate on your work. If you become tired or frustrated, leave it for awhile and rest.
- SECURE WORK.** Use clamps or a vice to hold work when practical. It's safer than using your hand and frees both hands to operate tool.
- CHECK DAMAGED PARTS.** Before further use of the tool, any part that is damaged should be carefully checked to ensure that it will operate properly and perform its intended function. Check for alignment of moving parts, binding of moving parts, mounting, and any other conditions that may affect its operation. Any damaged part should be properly repaired or replaced.
- DRUGS, ALCOHOL, MEDICATION.** Do not operate machine while under the influence of drugs, alcohol, or any medication.
- DUST WARNING.** The dust generated by certain woods and wood products can be harmful to your health. Always operate machinery in well-ventilated areas and provide means for proper dust removal. Use wood dust collection systems whenever possible.

# ADDITIONAL SAFETY RULES FOR WOODLATHES



**Warning!** Failure to follow these rules may result in serious personal injury.  
**Important:** ALWAYS BEFORE SWITCHING SPINDLE ON, CHECK SCREEN FOR CORRECT SETTING

- DO NOT MODIFY OR USE LATHE FOR USES OTHER THAN FOR WHICH IT WAS DESIGNED.**
- SEEK INSTRUCTION.** If you are not thoroughly familiar with the operation of woodlathes, obtain advice from your supervisor, instructor, or other qualified person. Instruction from a qualified person is strongly recommended.
- DO NOT OPERATE LATHE** until it is completely assembled and installed. Follow instructions and recommendations.
- FOLLOW ELECTRICAL CODES.** Make sure wiring codes and recommended electrical connections are followed and that the machine is properly grounded.
- WHEN REPLACING THE FUSE** (on relevant models). Completely isolate power when removing the fuse. It is imperative the plug is removed from the mains supply before the fuse is removed. Replace fuse cap before reconnecting to mains.
- DVR 3000 Do not open the switch and rear covers.** Components can carry dangerous voltages even when isolated from mains power.
- DVR 3000 Always ensure spindle fixtures (e.g. faceplates etc) are locked to spindle in case spindle reverse is engaged.** Otherwise they will unwind from spindle. See "Mounting a Faceplate to a chuck" section.
- WHEN SPINDLE REVERSE IS ENGAGED DO NOT USE CHISELS OR CUTTING TOOLS USE FOR SANDING ONLY**
- KEEP WORK AREA CLEAN.** Do not turn the lathe On before clearing the lathe of all objects (tools, scraps of wood, etc.). Keep the nearby area and floor clear of debris.
- CHECK SET-UP** with spindle Off. Examine the set-up carefully and rotate the work piece by hand to check clearance and check speed is correctly selected before turning on spindle.
- DO NOT MAKE ADJUSTMENTS** when the lathe or work piece is turning. Make all adjustments with power Off.
- TIGHTEN ALL CLAMP HANDLES** on the headstock, tailstock, and toolrest before operating lathe.
- EXAMINE WORK PIECE** and glue joints before turning to make sure it has no defects that would cause it to break when turning.
- DVR3000 ALWAYS CHECK CORRECT SPEED IS SELECTED BEFORE SWITCHING ON SPINDLE**
- USE LOWEST SPEED** when turning a new or unbalanced work piece.
- TURN AT RECOMMENDED SPEED.** Always operate the lathe at the recommended speeds. Consult this manual for suggested speeds.
- ADJUST TOOLREST** close to the work piece. Before turning, revolve the stock by hand to make sure it clears the rest. At intervals, stop the lathe and readjust the toolrest.
- KEEP TOOL ON TOOLREST.** The lathe tool or chisel should be on the toolrest before the lathe is turned On. Tools should remain on the toolrest whenever the tool is engaged in contact with the work piece **REMOVE TOOLREST** when sanding or polishing so fingers do not get pinched.
- USE CORRECT LATHE TOOLS.** Do not use spindle turning chisels for faceplate mounted work, and vice versa. Spindle turning tools used for faceplate mounted work may grab the work piece and pull the chisel from your control.
- WHEN ROUGHING STOCK** do not jam the lathe tool or chisel into work piece or take too big a cut.
- DO NOT POUND WORK PIECE** into headstock drive (spur) center when turning between centers. Pound the drive center into the work piece with a soft mallet before installing it between centers in the lathe.
- DO NOT USE TAILSTOCK** to drive work piece into the drive (spur) center when turning between centers. Secure work between centers with light pressure from the tailstock quill action.
- FASTEN STOCK SECURELY BETWEEN CENTERS.** Make sure the tailstock is locked before turning on the power.
- NEVER LOOSEN TAILSTOCK** spindle or tailstock while work piece is turning.
- CORRECT USE OF FACEPLATE.** When faceplate turning, make sure work piece is securely fastened to the faceplate and that appropriate size faceplate is used to support the work piece. Any screw fasteners must not interfere with the turning tool at the finished dimension of the work piece. Rough-cut the work piece as close as possible to finished shape before installing on faceplate.
- DO NOT OPERATE LATHE IF DAMAGED OR FAULTY.** If any part of your lathe is missing, damaged or broken, in any way, or any electrical component fails, shut off the lathe and disconnect the lathe from the power supply. Replace missing, damaged, or failed parts before resuming operation.
- ADDITIONAL SAFETY INFORMATION** regarding the safe and proper operation of this product is available from the National Safety Council, 444 N. Michigan Avenue, Chicago, IL 60611 in the Accident Prevention Manual of Industrial Operations and also in the Safety Data Sheets provided by the NSC. Also refer to the American National Standards Institute ANSI 01.1 Safety Requirements for Woodworking Machines and the U.S Department of Labor OSHA 1910.213 Regulation.

Guidelines to symbols used in this manual:



Warning Symbol. Pay close attention!



Note/Information Symbol. Please read - important information for you.

# DVR 3000 Woodlathe Specifications

**Size:** 1100mm(L) x 240mm (W) x 412mm(H)  
43 1/3"(L) x 9 1/2" (W) x 16 1/4"(H)

**Weight:** 82 kg (181 LB)

**Swing Over Bed:** 400 mm (16 in.)

**Distance Between Centers:** 600 mm (24 in.);  
expandable in 510 mm (20 in.) units with  
add-on Bed sections.

**Swing Outboard:** 740 mm (29 in.) with headstock  
at 90° using outrigger toolrest.

## Headstock:

Spindle Thread: M33 x 3.5 RH <sup>(1)</sup> or  
1-1/4 x 8 TPI RH <sup>(2)</sup>

Headstock Bore: No. 2 Morse Taper (#2 MT)

Headstock Swivel: 0 to 360 degrees, with  
detents at 0, 22.5, 45, and 90 degrees.

Outboard End Internal Thread: M20 x 1.5 LH

Spindle Index: 24 divisions (every 15 degrees)

15mm through-hole through Headstock

## Tailstock:

Tailstock Bore: No. 2 Morse Taper (#2 MT)

Quill Travel: 85 mm (3-1/4 in.)

Hole Through Tailstock: 15 mm (9/16 in.)

## Toolrest:

Length: 300 mm (12 in.)

Shaft Diameter: 25.4 mm (1 in.)

## Speeds (rpm):

100 – 3500 (in 5rpm increments)

## Standard Equipment:

300 mm (12 in.) Toolrest, 80mm (3 in.) Faceplate\* (Not  
all countries, see notes below), (Not all countries, see  
notes below) Spur Center, and Live Center. Outboard  
Handwheel.

## Nova 3000 Bowl Lathe Version:

Specifically for bowl turning, does not include bed  
extension, tailstock, and centers.

## Optional Accessories:

Nova Chuck System  
SuperNova Chuck System  
Faceplates: 80 mm (3 in.)  
Vacuum Faceplate  
Toolrest: 100 mm (4 in.)  
Bowl Toolrest  
Outrigger Toolrest Unit  
Vacuum Coupler  
Revolving Center System  
Ornamental Turner  
Faceplate rings

## Notes:

- (1) Applicable to Europe (excluding the UK)
- (2) Applicable to United States, Canada, United  
Kingdom, Australia, New Zealand & South Africa.

**i**\* *Note: Standard equipment varies from country to country.  
In the USA, the 80mm 3" faceplate is included with the lathe as  
standard equipment. In other markets, the faceplate is an  
optional accessory. Check with your reseller if you are unsure.*

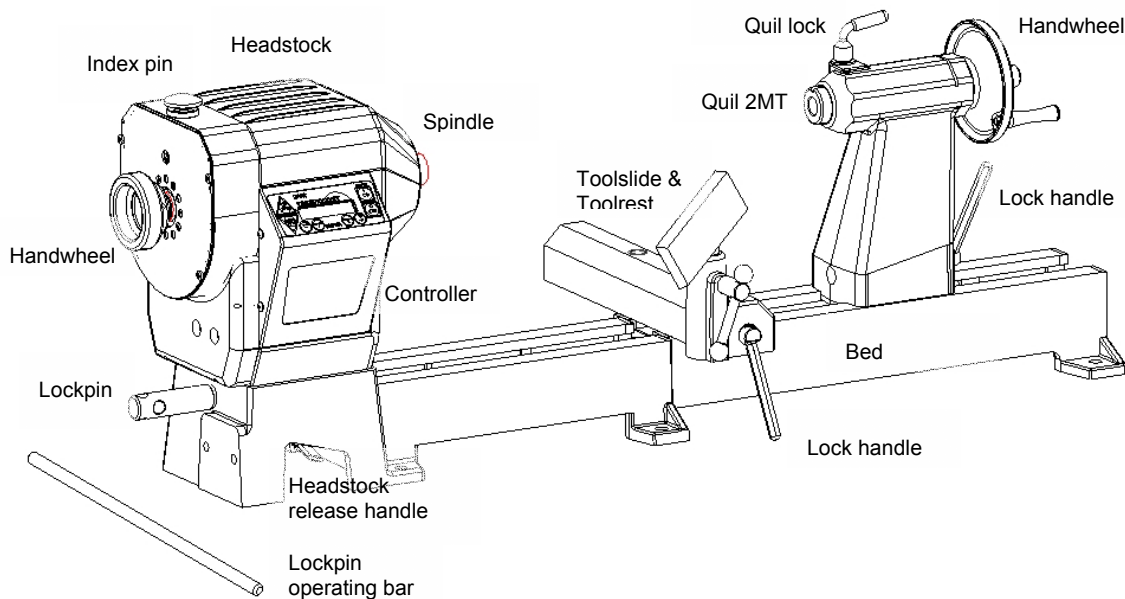



# Setting Up Your Workshop

## Workshop Requirements

<i>Consideration</i>	<i>Recommendation</i>
Lathe location	Locate the Nova DVR 3000 close to a power source in an area with good lighting. Leave enough clearance on all sides of the lathe; allow for motor clearance when the headstock is swiveled. Other machines in your shop should not interfere with the operation of the lathe.
Lighting	Your shop should have adequate lighting. The work area of the lathe should be well lit; there should not be shadows cast on your work. If possible, locate near a window. A portable spotlight may be helpful.
Electrical	The Nova DVR 3000 requires the appropriate power outlet nearby to power the motor. Wiring and outlets should adhere to local electrical codes. If in doubt, seek advice from an electrician. Minimize use of extension cords. See "Connecting to power" section for Surge Protector requirements.
Ventilation	Your shop should be adequately ventilated. The degree of ventilation will vary based on the size of the shop and the amount of work done. The use of dust collectors and filters will minimize risks to your health.

## Lathe Stand Recommendations

A sturdy and rigid stand is required so that the Nova DVR 3000 Woodlathe can deliver optimum performance. A common flaw with many woodlathe installations is an inadequate stand for the lathe. The larger the size of your turnings, the greater the importance of the lathe stand design.

<i>Consideration</i>	<i>Recommendation</i>
Lathe Height from floor	The height of the stand should locate the centerline of the lathe spindle at the elbow height of the turner.( illustration next page)
Stand Top	The stand top should be flat so the lathe does not twist when it is bolted down. Check for any gaps between lathe feet and stand top before bolting down. Shim and prepare stand as necessary..
Stand Weight	The stand should have enough weight and mass so it doesn't move when turning large work pieces, and so that the stand can absorb vibrations. A lathe stand's stability can be improved by weighing it down with sand bags on a lower shelf.
Stand Legs	The stand should sit level on the floor and not rock.

### Example of Shop-made Lathe Stand

This has been designed with economy of space in mind. Heavier sections, wider rails and gussets on the corners are encouraged. For stability and vibration dampening, it is highly recommended that the base is filled with sand.

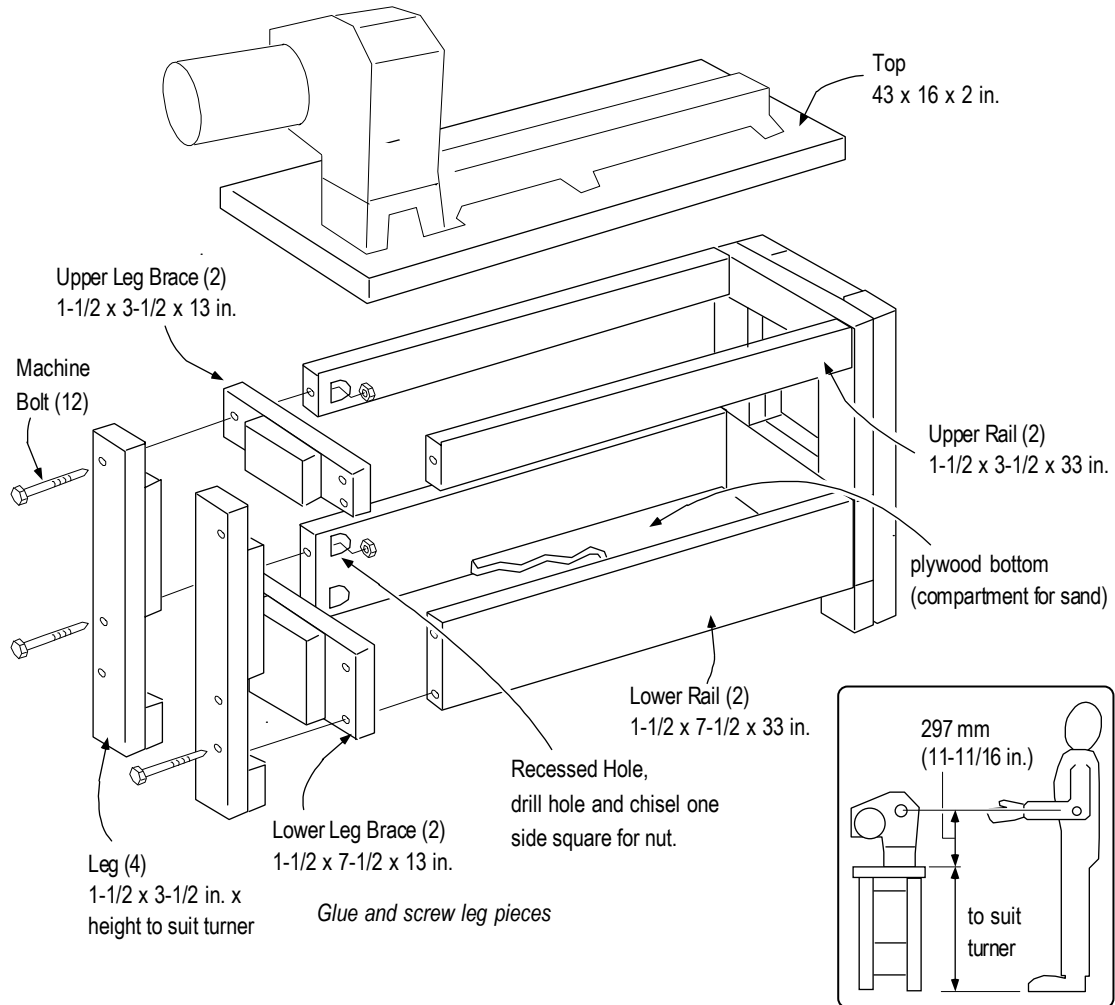

# Assembling the Nova DVR 3000

1. Unpack the lathe and components from the shipping container. This is best done by cutting down the sides of the box to expose the lathe



## Warning!

Have other people help when moving or lifting the Nova DVR 3000 Woodlathe; it weighs about 82 kg (181 LB).

2. Clean any parts coated with rust preventative with a cloth moistened with a petroleum-based solvent or cleanser, such as paint thinner. Coat the lathe bed with paste wax.

## Nova DVR 3000 Components After Unpacking

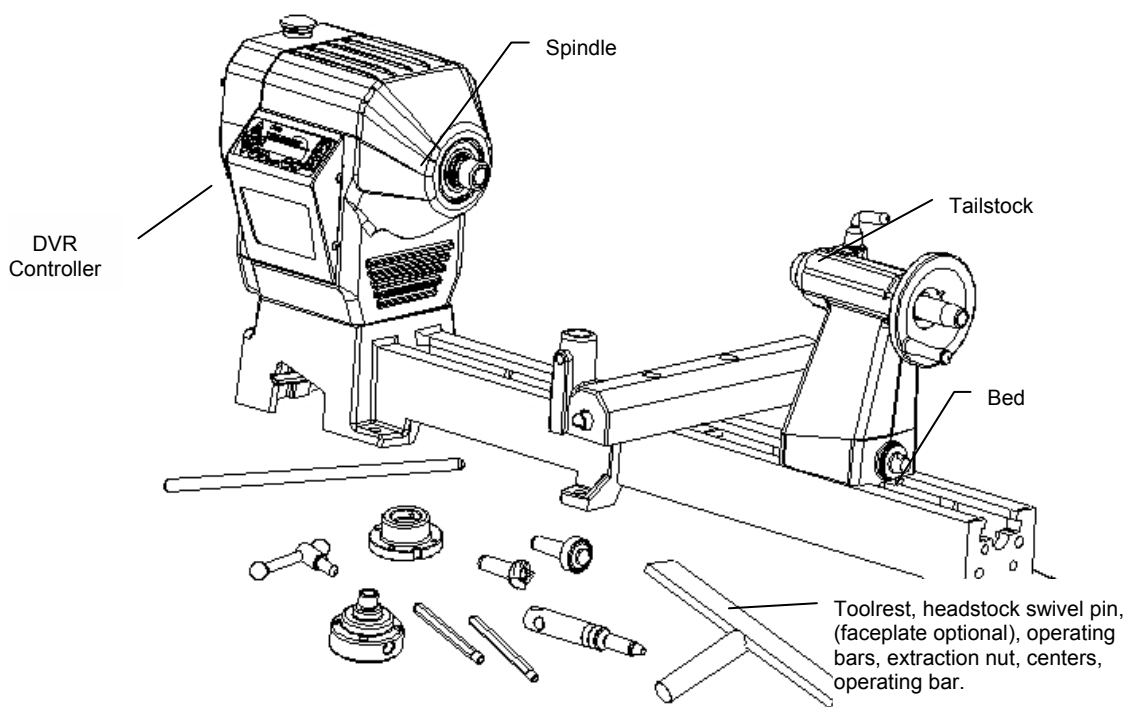

3. Remove the plastic shipping tube from headstock base. Screw the Headstock Lockpin into the threaded hole at the bottom of the headstock. Insert the operating bar into the hole in the Lockpin and firmly tighten the Lockpin to lock the headstock in position; then remove the operating bar. NOTE: When the pin is fully engaged the groove machined into the pin furthest from the thread should line up with the edge of the hole in the casting. By doing this the pin will be engaged in the hole of the swivel pin.
4. Push the Headstock Release Handle down and rotate the Headstock so the spindle points to the tailstock and lines up parallel to the lathe bed.

## Installing the Headstock Lockpin

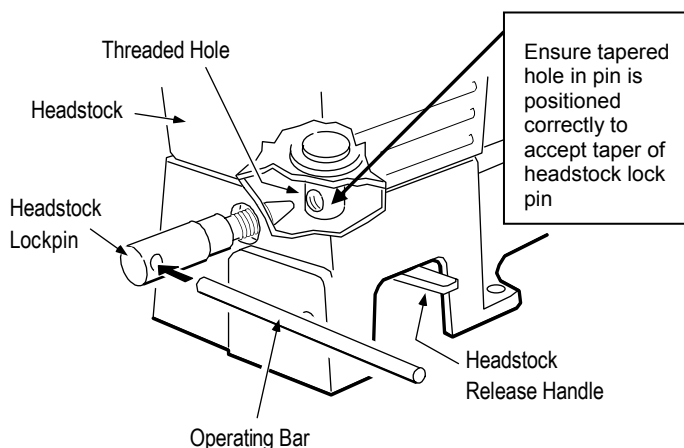

ⓘ Note: Do not use excessive force when tightening the Lockpin.

5. Assemble the handles:

① *Note: Some handles may come pre-assembled.*

Toolrest Clamp Handle - insert the rod through the handle and screw the ball knobs onto each end of the rod.

Toolside Clamp Handle - screw the rod into the toolside use a hex spanner to lock handle firmly in thread.

Tailstock Clamp Handle - screw the rod into the tailstock use a hex spanner to lock handle firmly in thread.

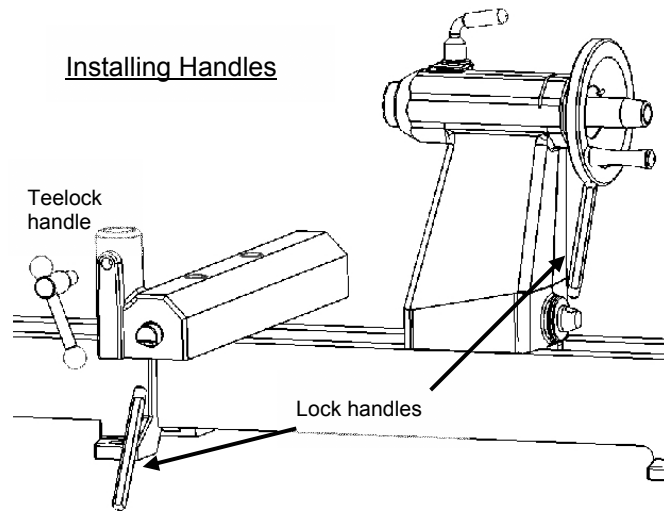

## Adding an Extension Bed

Each cast iron extension bed adds 510 mm (20 in.) to the lathe's capacity to turn between centers.

1. Clean the joining ends of both bed sections with a petroleum-based solvent. Make sure there are no dents or burrs on either mating surface. Remove burrs and high spots with a smooth file.
2. Gently tap the two dowel pins into the non-threaded holes of one of the bed sections, until they are flush with the holes inside the casting.

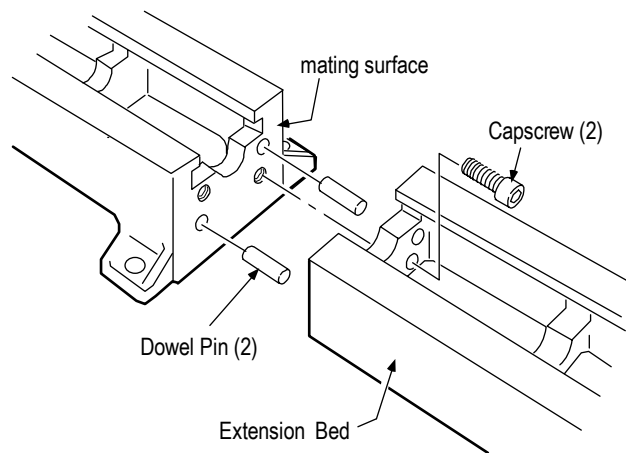

### Warning!

Do not use a metal hammer to pound directly on the extension bed. This may damage the bed, affect accuracy and tailstock action, which may prevent you from adding another extension bed. When using a metal hammer, always add a block of wood to the contact surface, to cushion the blow and prevent impact damage.

3. Line up the dowel pin holes of the add-on extension to the dowels and gently tap the end of the add-on bed with a rubber or wooden mallet (or using a metal hammer but with wood to cushion as noted above under the warning) until the two beds come together.

① *Note: Due to close tolerances between the Dowel Pins and the holes, tip -- putting dowel pins in your Freezer for at least 2 hours this will help to shrink them.*

4. Secure the bed sections together with two M12x30 capscrews using a 10 mm Allen wrench. It may be necessary to move the lathe so the capscrews can be reached with the wrench from the bottom of the bed.
5. Check that the toolslide and tailstock move freely over the mating joint and also over the full length of the add-on extension. If there is ridge between the two mating surfaces use a smooth file to file the surfaces flush.
6. Follow the suggestions under "Mounting the Lathe to a Support Surface".

## Mounting the Lathe to a Support Surface

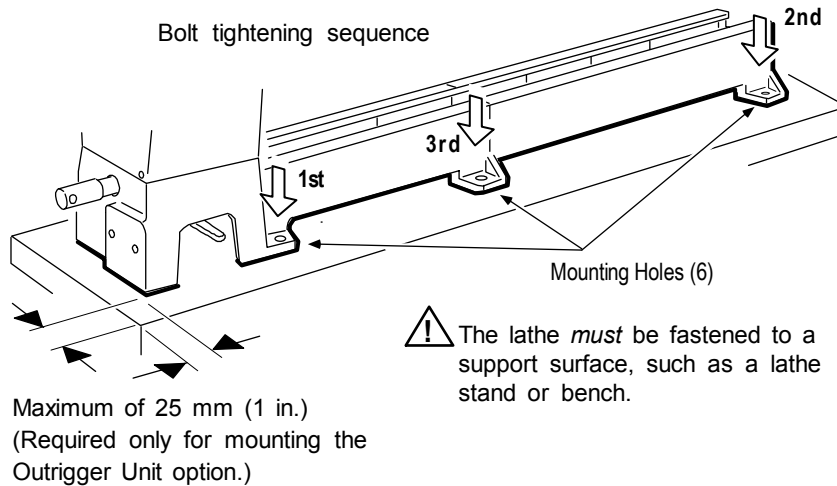

1. Place the lathe on the stand top. Locate the front and left corner of the lathe approximately 25 mm (1 in.) from the corner edge of the stand top. This provides a comfortable reach when turning and allows the optional outrigger unit to be easily installed.
2. If necessary, mark the six hole locations on the top and drill M12 holes.
3. Place a spirit level along the top of the lathe bed. Any movement of the bubble as the lathe is secured, indicates a twist on the bed. For the lathe to operate correctly the bed must not twist; if necessary, use shims between the bed and stand top.
4. Use bolts of suitable length (not included) to secure the lathe. Tighten the two headstock bolts first, then the two tailstock bolts, and finally tighten the two middle bolts.
5. The two M12 threaded holes underneath the outrigger end of headstock can be optionally used (making a total of 8 bolt positions). Ensure that the bolt is a metric M12 x 1.75 mm pitch and that the length is correct to ensure that the bolt doesn't bottom in the threaded hole and potentially damage casting.

## Connecting to Power

The power cord should be 3-wire, having a grounding conductor and a grounding plug. The plug must be plugged into a matching outlet that is properly installed and grounded in accordance with local electrical codes.



### Warning!

Improper connection of the motor can result in a risk of electrical shock.

If it is necessary to use an extension cord, the cord should be grounded. Use the correct wire size for the extension cord, for a given cord length, to avoid power loss and over-heating.



**IMPORTANT:** A Surge Protection Device rated to at least 15 amps - for USA and Canada, other countries 10 or 15 amps - **must be used** to protect the DVR electronics from electrical spikes or surges, similar to those used on most Home PC's. Ground Fault Interrupters (GFI's) or Residual Current Detectors (RCD's) are helpful and are a recommended protection device for any powertool. They can be used in conjunction with a DVR lathe without any problems.

**Stock Code: 55016 = 115v 15 amp wall connection.**

**Stock Code: 55077 & 55078 = 220-240v x 10 amp or 15 amp wall socket connection.**

# Using the Nova DVR 3000

## Parts of the Nova DVR 3000 Woodlathe

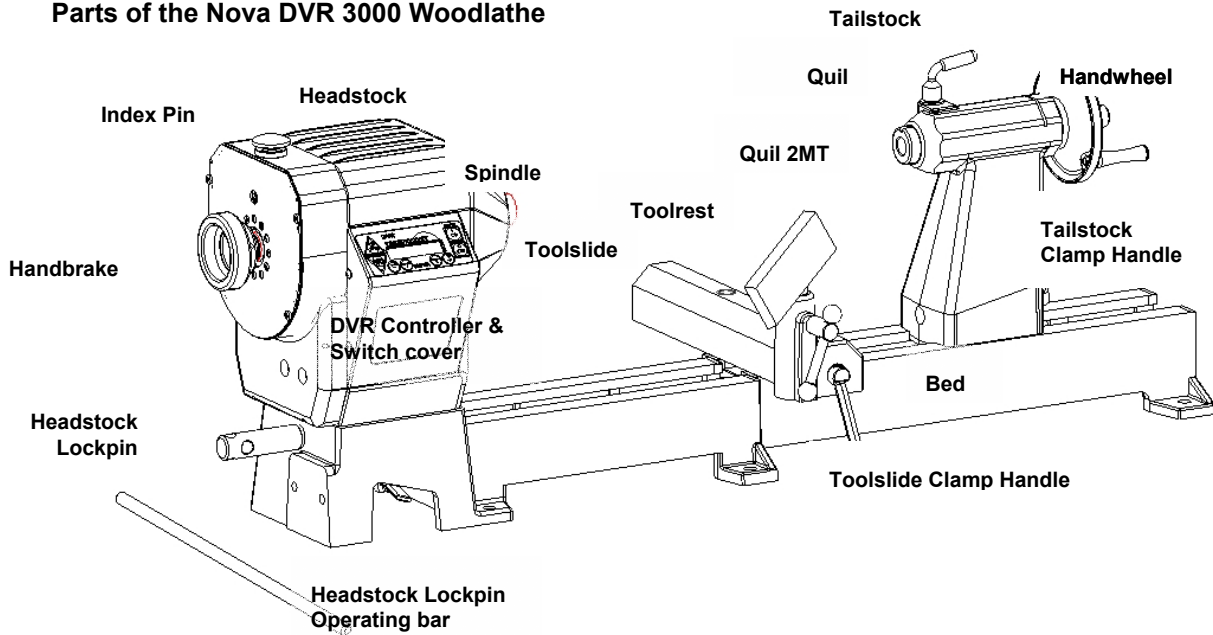

### DVR Variable Speed Controller

The Nova DVR 3000 drive is a unique type of motor and controller where the motor and controller interact. The motor provides data to the controller on its position and load conditions

The motor provides high torque even at low rpm and inherits extremely close speed control.

With the on /off switch in the Off position plug lead into wall socket and switch on.

An electronic tune will be heard as the controller computer "boots up" and the LCD display will show a two-line display.

### DVR Drive Parameters

Motor Type: Digital Variable Reluctance	Accuracy of Speed Stabilization: <2.5%
Motor Power: 1.30kW 1.75 Hp 115v, 2.3 Hp 230v	Regulator Type: PID
Efficiency: > 0.80	Speed Stabilization: Current level, pulse width
Motor Speed Range: 100-3500 rpm	Reverse: Yes
Default speed (when powering up) : 500 RPM	Speed Control: Button (5rpm increment)

## DVR Drive Functions

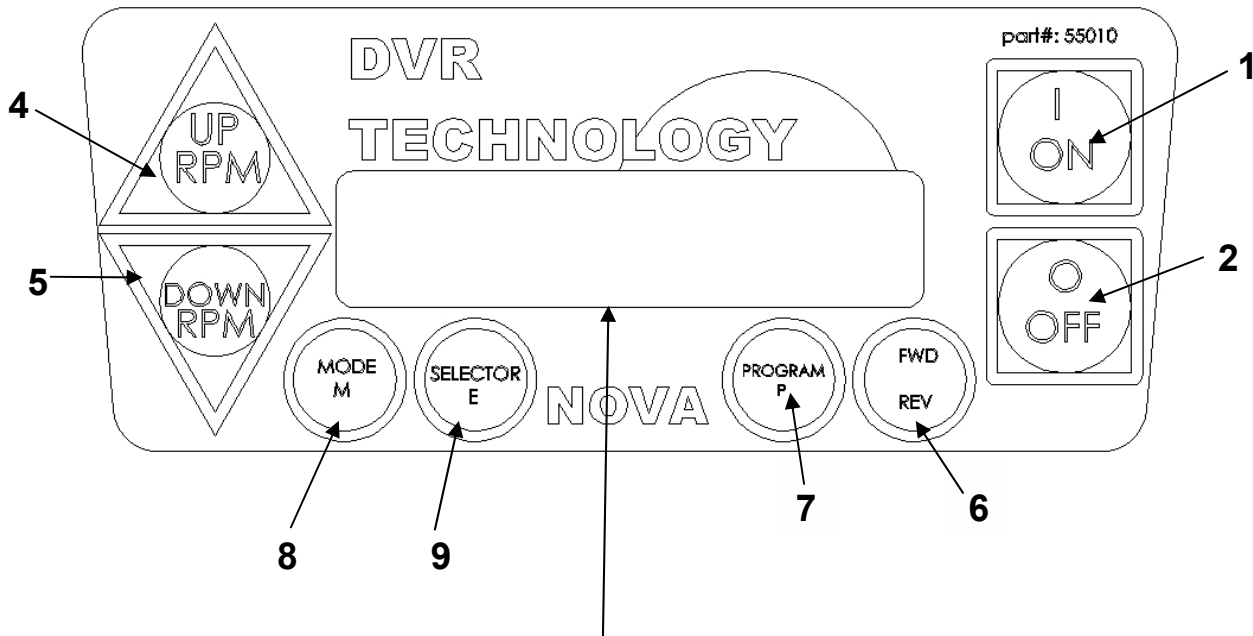

A two-string liquid-crystal display panel (LCD) displays the current information.

```
Ready to start
at XXXXrpm >>
```

“XXXX” is the reference motor speed.  
“>>” Indicates forward direction of rotation.

1. Green ON -- Press to start machine at the commanded speed -- always check that the **speed has been selected correctly. When the computer is first switched on it is set at a default speed of 500 rpm. Remember that whenever the computer is switched off at the wall or at the incoming power supply switch the computer will restart at the default setting. The spindle cannot restart until 1 “ON” is depressed.**

As with any Woodlathe ensure that the index is off and the workpiece is free to turn without hitting the toolrest etc. Ensure that the work piece is secure and the appropriate speed is selected.

```
Speed = CCCC rpm
Ref -> RRRR rpm
```

“CCCC” = current value of the motor speed

“RRRR” = reference value. (Value selected)

When the On button is first pushed the screen will display "Go Low!! rpm" and then "4 retries left". These messages are normal, the computer first does a self check.

2. **Red OFF key.** Pressing this key will switch motor off
3. The **ON / OFF** keys in the above panel only switch the motor on and off. The selected speed will remain until adjusted or computer switched off.
4. **UP RPM.** To raise speed one press of the key will increase speed 5 rpm. Continuing to hold key pressed will continue to raise speed. The speed can be adjusted with the spindle running or off. To make a large adjustment in speed it is quicker when the spindle is OFF.
5. **Down RPM.** Press to lower speed this key operates the same as up key.  
The UP and Down keys can also be used in program mode to change the parameters.
6. **FWD / REV keys.** Pressing this key will change the motor rotation from forward to reverse. Pressing again will select forward. You can verify the direction by the two arrows at the bottom left or right of the screen. **Important always verify the forward or reverse is selected correctly before switching spindle on.**

The Direction of rotation setting is only available in the ready to start mode, Press stop if necessary, Press FWD/REV to toggle direction of rotation. The two arrows on the left side indicate reverse.

Whenever reverse is selected a " Warning Reverse Selected " will flash on screen for about 1-2 before spindle starts.

### Special and Parameter settings



You may wish to change the stabilization setting from time to time depending on the type of work piece you are working on. You have 3 options preset for you:

1. SOFT: For light work at speeds lower than 500 rpm
2. NORMAL: Suitable for most work and is the default setting
3. HARD: For heavy and/or 'out-of-balance' work at speeds lower than 500 rpm

a) Press **<OFF>** if necessary.

b) Press **<PROGRAM>**. The stabilization setting will be displayed. The default setting is NORMAL

c) Press **<SELECTOR>** to toggle between the 3 options as mentioned above.

**NOTE:** Pressing the **<MODE>** allows the user to change the parameter settings in more detail. This breaks it down into Proportional (Kprop) and Integration (Kint) settings which make up the PID control of the DVR. The 3 options of SOFT, NORMAL and HARD have been preprogrammed for your convenience and are balanced for optimum output. To clear special settings and return to default --- switch off computer at the master switch.

d) Press **<PROGRAM>** button to return to ready state. (Ready to start mode).

While the machine is running if you push Mode (8) the screen will display various diagnostics. Operation of the machine is not effected. Each time mode is pressed a different screen will show. This area is only used for advanced programming functions.

Auto safety -- If the power is lost to the machine, when power is restored the computer will reboot but the machine will not start until the 'ON' switch is pressed. **Remember to correctly select speed if different from Default speed.**

**Warning: Do not push several keys together as special coded combinations of keys open diagnostic and service functions. Some of these disable control and protection functions. If an unfamiliar screen is displayed, switch off the computer and leave for one minute before rebooting.**



## Turning Tips

The Nova DVR 3000 drive technology is not just a variable speed motor -its smart motor technology takes turning to a new level. The speed / vibration and load sensing work with the conditions and turning. The machine will reward skilled turning with exceptional finish conditions. Often no need for sanding. As you apply load (chisel pressure or depth of cut) the control will sense the change in spindle conditions and compensate accordingly. Get a feel of the communication between yourself and the motor turning by applying increasing force, the motor will respond by applying increased power to exactly maintain speed.

LOW SPEEDS 100-350: Select Hard Mode ( see Special and Parameter settings)

Note – at low speeds 100- 350 control of the chisel is important. At 250 rpm the motor still has good torque ( in fact the torque is more or less the same as at 400 or 1000 – but at low speeds there is a difference , the DVR is a unique type of motor in that the control only supplies enough power to maintain the spindle at the commanded speed. It needs to sense the load from the chisel and then it will apply power as needed. At very low speeds the chisel can move fast compared with the rotation of the wood. The important thing is to have good control of the chisel and maintain steady cuts (using the same woodturning practices that produce quality cuts and finishes). In this way surprisingly heavy cuts can be achieved. However rapid or incautious use of the chisel will be immediately sensed by machine and spindle will shut down and then automatically try a restart.

“Will The Machine Shut Down on Interrupted Cuts?” No, as long as the cut is within the normal range of Woodturning cuts. An interrupted cut at slow rpm may cause a loss of control of the chisel and a dig in may occur.

A way to understand chisel feed rates is to consider that at 100 rpm the work piece has only rotated about 1 and a half turns in one second and at 250 rpm, 4 turns. Considering that chisel feed or movement under normal turning can be anything between say 5 and 100mm per second at normal Woodturning turning speeds. At very low rpms it is easy to move the chisel too fast for good cutting conditions. In general low rpm is only used for special processes or conditions. Speeds below 350 are generally not Woodturning speeds. The machine will operate down to 100 rpm but this is generally for applying finishes and other applications.

## Swiveling the Headstock

1. Stop the lathe. Insert the operating bar into a hole in the Headstock Lockpin. Loosen the Lockpin half a turn.
2. Slide the Headstock Release Handle towards outboard end of lathe, and rotate the headstock to a detent position. Do not push down on the handle.



### Warning!

Use the detent latch positions to prevent headstock movement during turning.

4. Firmly tighten the Headstock Lockpin with the operating bar; but do not use excessive force. Remove the operating bar.

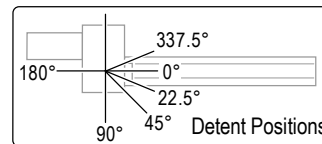
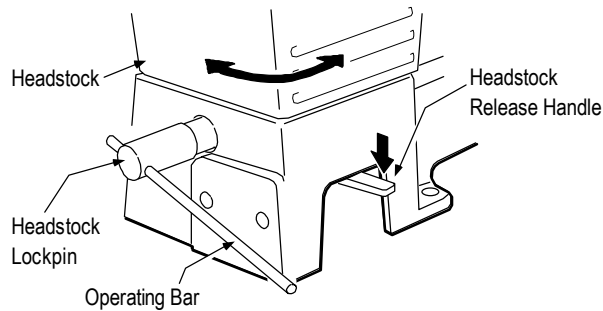

	<i>Right-hand Turners</i>	<i>Left-hand Turners</i>
<b>Detent Positions</b>	0, 22.5, 45, 90 degrees	180, 337.5 degrees

## Spindle Index

The spindle index pin locks the headstock spindle. It is selectable in 15 degree increments (24 divisions). There is sight hole to read index numbers (0 through 23).

1. Stop the lathe.
2. Pull the index knob and turn it left until the pin drops into the hole. To lock the spindle it must engage into a hole in the headstock pulley.



### Warning!

Make sure the index pin is out before operating the lathe. The pin should drop into the indentation in the headstock to prevent it from engaging while the spindle is turning.

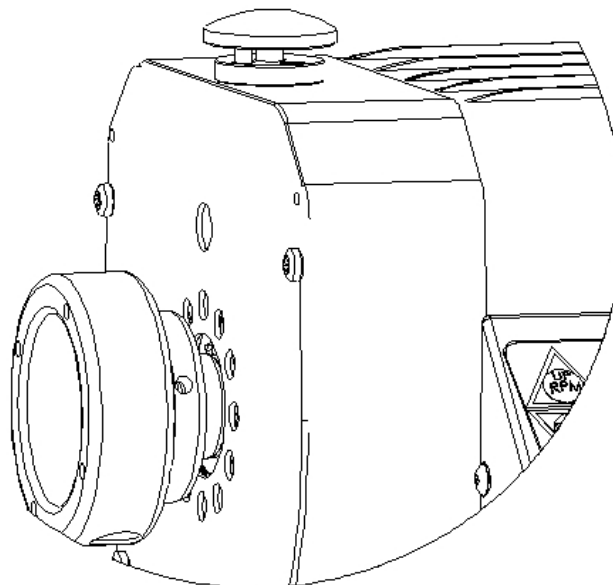

<i>Divisions</i>	<i>Index Number</i>	<i>Degrees</i>
2	0, 12	180
3	0, 8, 16 (every 8th)	120
4	0, 6, 12, 18 (every 6th)	90
6	0, 4, 8, 12, 16, 20 (every 4th)	60
8	0, 3, 6, 9, 12, 15, 18, 21 (every 3rd)	45
12	0, 2, 4, 6, 8...22 (every 2nd)	30
24	every hole	15

## Headstock

The headstock houses the Rotor, Stator, Electronics, bearings, and the Spindle. The headstock spindle accepts centers and accessories with no. 2 Morse taper (#2 MT), plus threaded faceplates and chucks.

### Spindle Thread Size

Country	Threads
United States, Canada, Australia, New Zealand, South Africa, United Kingdom.	1-1/4 x 8 TPI RH
Europe (excluding the UK)	M33 x 3.5 RH

### Mounting a faceplate or chuck

1. Use the spindle Index Pin to lock the headstock spindle.
2. Remove the side-locking screw, then wind the faceplate or chuck onto the spindle threads. A spindle washer in-between may be used to make removal easier.



#### Warning!

The faceplate or chuck body must contact the shoulder on the spindle bearing.

3. Pull and turn the Index Pin and place it in the "safe" indentation in the headstock.
4. A vee groove is provided in the spindle for special locking grubscrew that is used in conjunction with Nova chucks and accessories to prevent unwinding during reverse operations. Wind in the side-locking grub screw and lock firmly in place, without over tightening.



#### Warning!

It is important that the all Chucks and Faceplates that are used on the DVR spindles have a side-locking function.

Some older Teknatool products may not have a side-locking function. If any of these products are intended to be used on the DVR spindle they will need to undergo a modification to include the side-locking function or new products purchased with a side-locking function. All spindle mounted products produced by Teknatool International for the DVR Lathe have side-locking functions\*.

The side-locking function should be used at all times while running the chuck on the spindle during operation. Without this function engaged the Chuck or Faceplate may unwind from the spindle during operation.

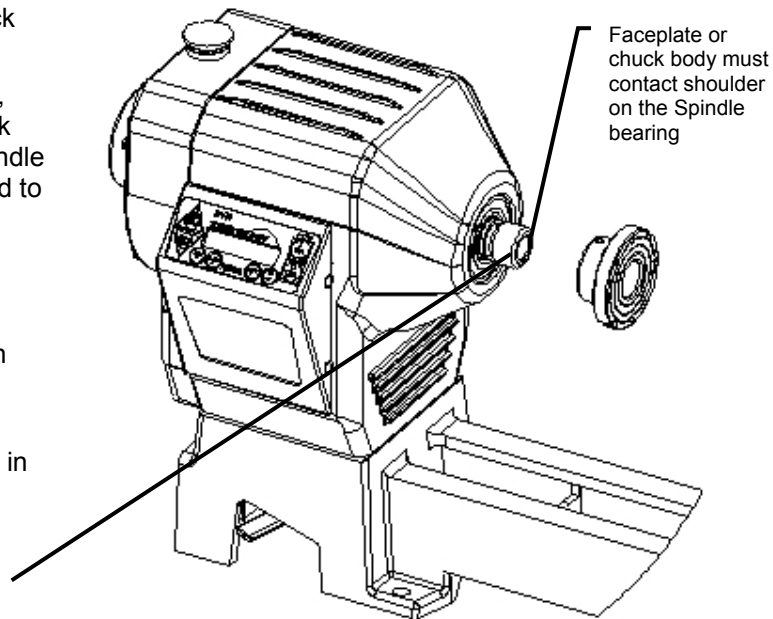

#### Warning!

When installing or removing the Faceplate or Chuck from the spindle, the side-locking grub screw **MUST** be completely removed.

This avoids any potential damage to the spindle that the grub screw may cause if it were not completely removed, when winding the Faceplate or Chuck on or off the spindle.

*\*Exception 1.* When an ILNS insert is used with a FP150Z faceplate on the DVR3000 or a Spindle adaptor, the insert or adaptor must be Loctited onto the faceplate to avoid it unwinding when the spindle is run in reverse. Loctite 272 Threadlocker is recommended.

*\*Exception 2.* Customers with dedicated threaded Teknatool chucks who intend using the chuck on the DVR Spindle must have a side-locking function adapted to the chuck before running it. Chucks with M33 threads may apply for Europe.

## Using a spur center

Mount the spur center to the work piece as shown and then insert the spur center and work piece into the headstock spindle.



### Warning!

Do not pound work piece into headstock drive center when turning between centers or you may damage the headstock.

To remove the center, insert a 10 mm (3/8-inch) diameter wooden dowel or steel rod through the headstock spindle hole. While holding the center so it doesn't fall, tap it out.

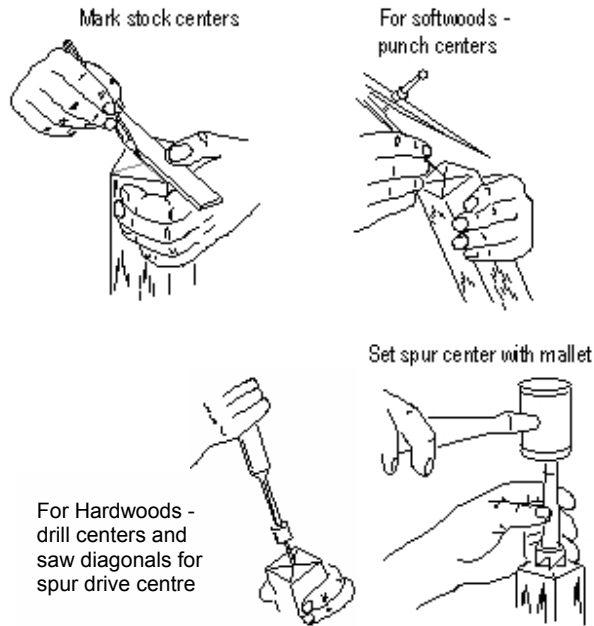

## Toolrest

To move the toolslide along the bed, loosen the Toolslide Clamp Handle, move the slide to the desired position, and tighten the clamp handle.

To adjust the toolrest, loosen the Toolrest Clamp Handle, position the toolrest, and tighten the clamp handle.

Adjust the toolrest close to the work piece. Exact positioning may be varied to suit the turner. Before turning, revolve the stock by hand to make sure it clears the rest. At intervals, stop the lathe and readjust the toolrest.



### Warning!

Lathe tools and chisels should remain on the toolrest whenever the tool is in contact with the work piece. Remove the toolrest when sanding or polishing so fingers do not get pinched.

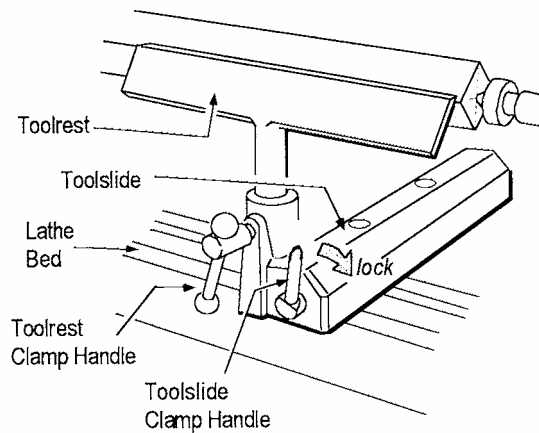
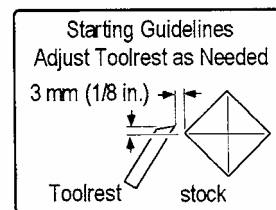

## Lathe Turning speeds

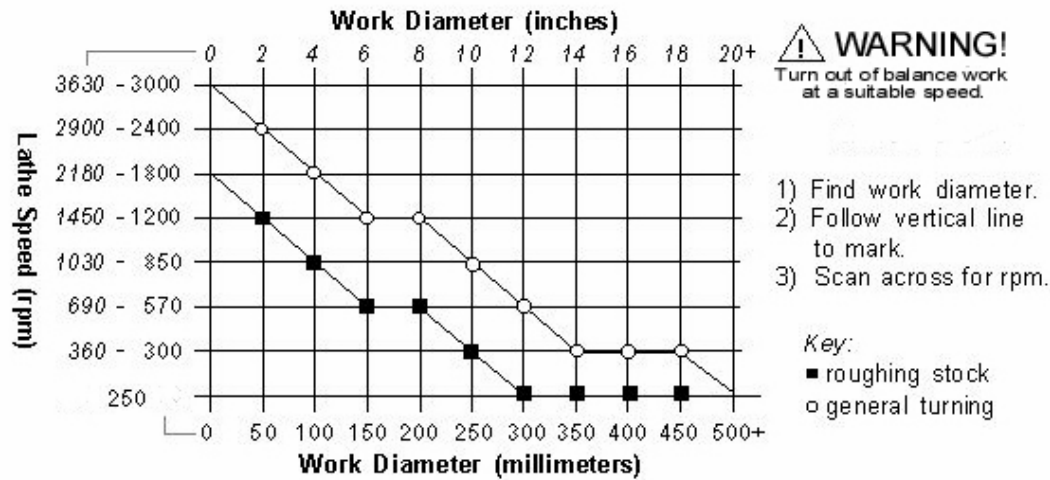

Correct selection of turning speeds is important for safety and finish cut quality

It is important to take into account the fixing of the work piece, it should be made as secure as possible. Various techniques are available for this consult books on the subject and seek training opportunities.

There are safety and out of balance considerations. Aim for a good balance in turning speed, ensure good fixing and try to balance timber as much as possible before installing on lathe.

In general wood likes being sliced and if too low a speed is used the timber can "hammer" against the cutting tool, tearing fibres and imposing large forces on tool and work piece. This can often be dangerous, it is best to select a higher speed, the cut will be smoother and less force is imposed on work piece. It can be likened to a wood plane, if it is pushed very slowly much force is needed to break the fibres, if the plane is pushed at a higher speed less forces are involved and a better cut results. Use 250 when needed, but better turning 400-600.

## Tailstock



### Warning!

Never loosen the tailstock quill or tailstock while the work piece is turning.

To move the tailstock along the bed, loosen the Tailstock Clamp Handle, slide the tailstock to the desired position, and tighten the clamp handle.

To move the tailstock quill in or out, loosen the Quill Lock and turn the Handwheel. Lock the quill in place with the Quill Lock.

The tailstock quill accepts centers and accessories with no. 2 Morse taper (#2 MT). To install a taper use a quick, firm action by hand. Do not pound the taper in.

To remove a taper, insert the operating bar through the tailstock quill hole. While holding the taper so it doesn't fall, tap it out.

The tailstock quill is hollow, allowing you to bore holes through turnings if a hollow center is used.

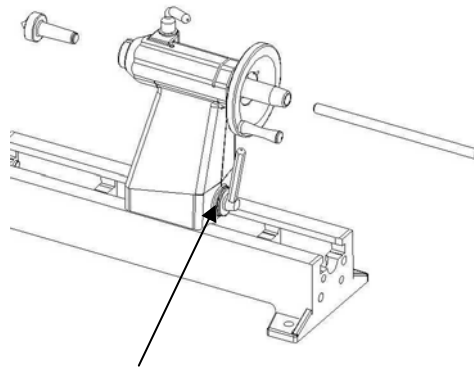

Operate Cam Lock Lever to release and lock tailstock. Can be operated forward or back, whichever is convenient.

## Learning Turning

The art and technique of turning is a subject beyond the scope of this instruction manual. It is recommended that you receive hands-on instruction on lathe turning and/or refer to books and videos on the subject. For reference, some woodturning books are:

*The Lathe Book*  
By Ernie Conover

*Woodturning A Foundation Course*  
by Keith Rowley

*Creative Woodturning*  
by Dale Nish

*Turning Wood With Richard Raffan*  
by Richard Raffan

*The Fundamentals of Woodturning*  
by Mike Darlow

# Maintaining the Nova DVR3000

**General Maintenance --Always isolate from power supply (unplug) before carrying out any maintenance**

<i>Interval</i>	<i>Maintenance</i>
After each use	Clean the work area and Lathe. Vacuum shavings and dust from the Headstock, Tailstock, under the Toolslide and in between the bed.
Monthly	Wax exposed cast iron parts with a good quality paste wax, especially the bed rails. Buff out the wax thoroughly. Check tightness of nuts and bolts Lubricate, with one or two drops of light-weight oil, the tailstock quill threads, index pin shaft, and the toolslide camshaft (remove plastic plugs) and toolslide front camshaft bore.
6 Months	Grease tailstock quill threads. Turn the handwheel so the quill threads are exposed, apply grease to the threads, crank the handwheel back and forth to work in the grease, wipe off any excess Lubricate the tailstock slot with one or two drops of light-weight oil. With the power switched off and dis-connected, remove the upper-rear guard and remove any wooddust with a vacuum cleaner. Avoid getting the nozzle too close to the filter and electronics. After this step dust may fall into the Headstock so suck the dust out through the vent at the front of the Headstock under the spindle. Replace guard.

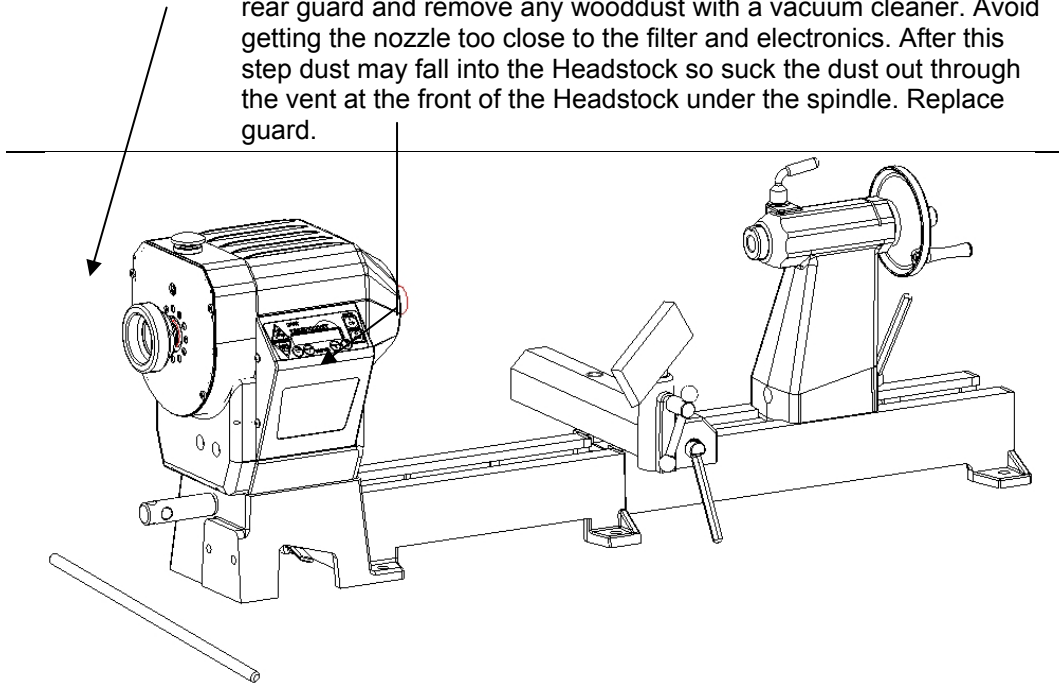

## Cleaning the Toolslide

If the toolslide becomes hard to move and adjust, cleaning and lubricating are required.

1. To make the toolslide slide more freely along the bed, make sure the bed rails are clean. Apply some paste wax to the rails.
2. If the toolslide is hard to move towards or away from you, remove the toolslide from the lathe bed. Clean the toolslide camshaft (round eccentric rod) with a petroleum-based solvent. Lubricate the rod with a lightweight oil or a silicone spray.
3. Slide the base back onto the lathe bed.

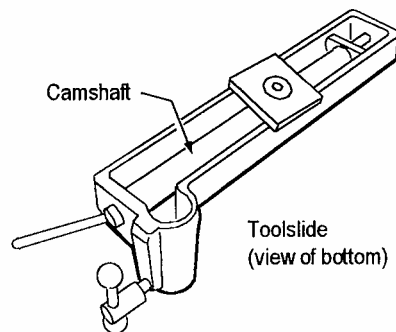

## Cleaning the Tailstock

If the tailstock quill becomes hard to use or the Handwheel is hard to turn, cleaning and lubricating are required.

1. Remove the 6 mm set screw from the tailstock. If necessary, turn the Handwheel to expose the set screw.
2. Using a screwdriver, remove the keeper plate from the tailstock body.
3. Remove the quill and Handwheel from the tailstock body.
4. Wipe clean all parts including the inside of the tailstock.
5. Lubricate the quill and tailstock slot with a lightweight oil and apply a small amount of grease to the quill threads.
6. Reassemble.

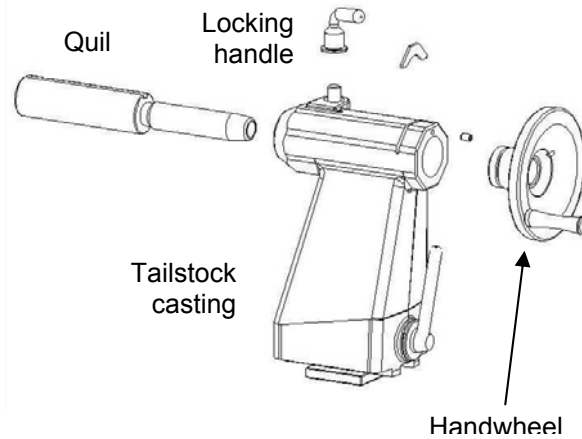

## Troubleshooting Guide

<i>Problem</i>	<i>Possible Cause and Solution</i>
<i>Excessive vibration.</i>	<p>Out of balance, or large work piece. Reduce lathe speed to the lowest speed possible and turn the work piece to a true circle. Adjusting the speed using the up / down keys will change the speed in 10 rpm increments. If you try adjusting the speed up or down you will find that it is easy to find speed points that will minimize vibration and is one of the biggest advantages of DVR technology.</p> <p>Work piece is not held in the center. Check work piece mounting and correct.</p> <p>Work piece is not secure or held tight enough. Check work piece mounting.</p> <p>Lathe incorrectly bolted to stand or bench. Refer to this manual for lathe stand recommendations.</p> <p>Stand or bench not well constructed, too light, or not level on the floor. Make sure the stand is solidly constructed. Use sandbags to weigh down the stand.</p> <p>The metal floor stand should be Rawl bolted to the floor at the 4 hole points.</p>
<i>Faceplate or chuck running out of true.</i>	<p>Dirt build-up on the rear of the faceplates or chuck. Clean off all build-up and dirt. Faceplates and chucks must mount securely against the inner bearing ring surface of the spindle.</p>
<i>Turning tools not sliding smoothly across Toolrest.</i>	<p>Damaged surface on toolrest face caused by sharp edged tools. File the toolrest using a fine smooth file and polish with extra fine sandpaper. Also remove the sharp edges from the corners of turning tools.</p>



*Spur drive center or live center not holding into the spindle taper or quill taper when turning.*

Small end of Morse taper is damaged due to dropping or hitting. File or polish away any damage. Check that inside of tapers have not been scored.

Grease or oil inside of Morse tapers. Wipe clean the inside of the tapers.

Insufficient pressure when installing the center. Use a quick, firm action by hand to install a taper. Do not knock in using any solid object.

*LCD screen not on*

- *Is master switch on? Toggle master switch to "Up" position.*
- *Check machine is plugged into wall socket and switched on*
- *Check that the wall switch plug is live by plugging in another power tool if the other power tool doesn't go check your board fuse.*
- *Check the master fuse on the lower rear guard Ensure machine unplugged (see Additional safety rules at the front of this manual). If blown, replace with the spare fuse that comes with the lathe. Do not replace with a higher amp fuse.*

*LCD screen shows*

**Rotor Fault**  
**<Flashing>**

*Press off button; switch off computer by master switch wait one minute and switch on again. Check that the spindle index is not engaged or that something is preventing the spindle from turning. Note leaving the spindle index unit in will not harm the motor, however it will put some strain on the index unit. It is likely that the spindle index will be left in from time to time and the motor is designed for this.*

**RP State Error**  
**<Flashing>**

*The optical sensors that give the spindle position feedback ('Rotor Position' State) are obscured, damaged or have been disconnected. Dust over a long period of time may have settled on the sensors. Firstly spin the spindle by hand to create a draught through the sensors. Re-try the motor. If the error remains, with the power switched off and disconnected, remove the upper-rear guard and remove any wood dust with a vacuum cleaner. Avoid getting the nozzle too close to the filter and electronics. After this step dust may fall into the Headstock so suck the dust out through the vent at the front of the Headstock under the spindle. Do this sequence a few times. Try blowing if available with Vacuum or Air gun. Replace guard.*

*LCD screen shows*

**PFC Corrector**  
**<Flashing>**

*The computer has built in voltage condition and temperature sensors, if this message appears check the temperature of the lower section of the headstock. If it is very hot, switch off the master switch and leave the machine to cool down for a period. If the headstock is relatively cool The computer may have detected an under and over voltage from the mains power. Switch off and try re booting. The DVR has a high level of protection and is intelligently checking conditions all the time.*

❗ *Note: Can't find the answer in this Trouble Shooting guide?*

*Visit the Lathe Support Section on our website - this is packed with Frequently Asked Questions.*

*Or*

*Contact Us (details are at the front of this manual)*

## Troubleshooting Guide continued

<i>Problem</i>	<i>Possible Cause and Solution</i>
<i>Difficulty in Adding Bed Extensions.</i>	The alignment pins for the bed extension can be a very tight fit - to help ensure accurate bed/tailstock alignment. Try putting the pins in the freezer overnight, and heating up the bed segments with a hot air gun or dryer. This slightly shrinks the pins and expands the holes they go into.
<i>Tailstock and headstock center not lining up correctly.</i>	Note: The Tailstock on the DVR3000 is non-adjustable. Bed incorrectly bolted to stand causing twist. Ensure stand and lathe are correctly installed. Headstock not returned to detent position after it has been rotated. Ensure that the headstock is locked into a detent position. Headstock Lockpin not fully seated. Twist the headstock back and forth to make sure it is properly seated and then tighten the Lockpin. Dirt or wood dust accumulated in the headstock swivel pin hole. Remove the Headstock Lockpin and clean out hole.
<i>Tailstock Handwheel hard to turn or will not turn.</i>	Quill lock is locked; unlock the quill lock. If necessary, lightly tap a block of wood against the handwheel handle; tap the handle in a clockwise direction as viewed from the tailstock end. Build up of dust and wood resin on the quill or inside of the handwheel thread. Remove, clean, and lubricate the quill and tailstock as described under "Cleaning the Tailstock". The quill has been extended too far and is locked against the handwheel. Push the quill back into the tailstock when turning the handwheel.
<i>Tailstock quill hard to move.</i>	Quill lock is locked; unlock the quill lock. The quill is damaged; turn the handle to expose the quill and check for marks along the quill, especially on the edges of the slotted keyway. Remove the high spots with a smooth file and test the quill travel. Replace the quill if necessary.
<i>Tailstock not locking correctly onto bed, or tailstock not sliding smoothly on bed ways.</i>	Tailstock adjustment plate not adjusted correctly; adjust as described under "Aligning the Tailstock". Dirty bed ways and underside of tailstock body. Clean bed ways and underside of tailstock body with a petroleum-based solvent.
<i>Tailstock binds.</i>	The inside of the bed has a high spot. File the area with a smooth flat file until the tailstock moves freely. The tailstock adjustment plate has a rough spot or a burr. Remove the tailstock and file the plate with a smooth flat file.
<i>Tailstock jumps where bed sections join.</i>	The machined flat surfaces are not flush. File the area with a smooth flat file until the tailstock moves freely.

# DVR 3000 Woodlathe Parts List

Item#	Qty	Part #	Description
1	1	24000	Main bed casting
2	1	24001	Bed Extension casting
3	2	24041	Dowel Pin D12x30
4	2	24011	Cap Screw M12x30
5	1	55017	Tailstock casting machined
6	1	55025	Camshaft - Tailstock
7	1	55026	Shaft - quill lock
8	1	55027	Sleeve - camshaft
9	1	55028	Quill - Tailstock 1.5" dia
10	1	55037	Dowel pin 6x16mm
11	2	24048	Camnut - Tailstock/Toolslide
12	1	24043	Handwheel casting
13	1	24065	Handle - Handwheel
14	1	55029	Lever - Quill locking
15	1	24040	Keeper plate
16	1	G0810	M8x10 Grubscrew
17	1	FW12	M12 Flat Washer ZP - Tailstock
18	2	24016	Lock arm - Tailstock/Toolslide
19	2	K1225	M12x25 Countersunk screw
20	2	27002	Lock plate Tailstock/Toolslide
21	2	G0610	M6x10 grub screw
	1	TP0820	Tension Pin 8x20
23	1	24009	Toolslide casting
24	1	BNMZ12090	M12x90 Hex bolt
25	3	FW12	M12 Flat Washer ZP - Toolslide
27	1	24020	Camshaft - Toolslide
28	2	865913	Plastic ball - Tee lock arm
29	1	24026	Teelock body
30	1	25001	Teelock arm - threaded M6
31	2	HP-16	Hole plug
33	1	TR300/1	Toolrest 300mm
34	1	55000	Headstock casting
35	1	55039	Aluminum (heatsink)
36	1	55013	Endcap housing casting
37	3	62072RS1	Trimax bearings
38	1	55003	Headstock Spindle 1 1/4" 8 UNS RH
	1	55103	Headstock Spindle M33x3.5 RH
39	1	55014	Front control cover
40	1	55019	Interface board
41	1	55049	LCD Interface board
	1	55010	Keypad membrane

## DVR 3000 Woodlathe Parts List

Item#	Qty	Part #	Description
	4	K0310	M3x10 Countersunk screw
44	1	55047	Guard Perspex
45	1	55005	Spacer ring
46	1	55006	Encoder ring
47	1	55004	Position disc
48	1	55040	Backing plate
49	1	55007	Rotor Lamination set
50	1	55050	Rotor key
51	1	EC35	Circlip- rear bearing
52	1	55051	Fan key
53	7	MP05010	M5x10 Pan pozi screw
54	4	STPB8X3/8	Gauge 8x3/8" mush self tapping screw
55	1	55018	Main control board
56	1	55011	Fan/Index plate
57	1	55032	Sheetmetal endcap guard
58	1	55012	Swivel pin - Headstock
	1	EC25	Circlip - swivel pin
	1	G0606	M6x6 grub screw - Fan
	4	K0616	M6x16 Countersunk screw (to fix Endcap to Headstock)
62	1	55033	Index pin - Fan
63	1	55036	Index knob
64	1	55035	Index guide bush
65	1	NHH16	M16x2 Half-nut
66	1	TPI31658	3/16"x5/8" Tension pin
	1	55137	Lockwasher ZP M16 (not illustrated)
67	1	24023	Detent pin
68	1	24060	Detent spring
69	1	NH28	M8 nut
70	1	24088	Detent lever
71	1	LHB	Handbrake Handwheel (replaces 55052 Extraction nut)
72	1	55048	Lock pin
73	1	55081	Locking lever 1/2"

## Sub assemblies

	1	24057	Teelock assy - Toolslide
	1	24068	Handwheel assy - Tailstock

# Nova DVR3000 Lathe 1 1/4" 8 UNS RH Spindle thread

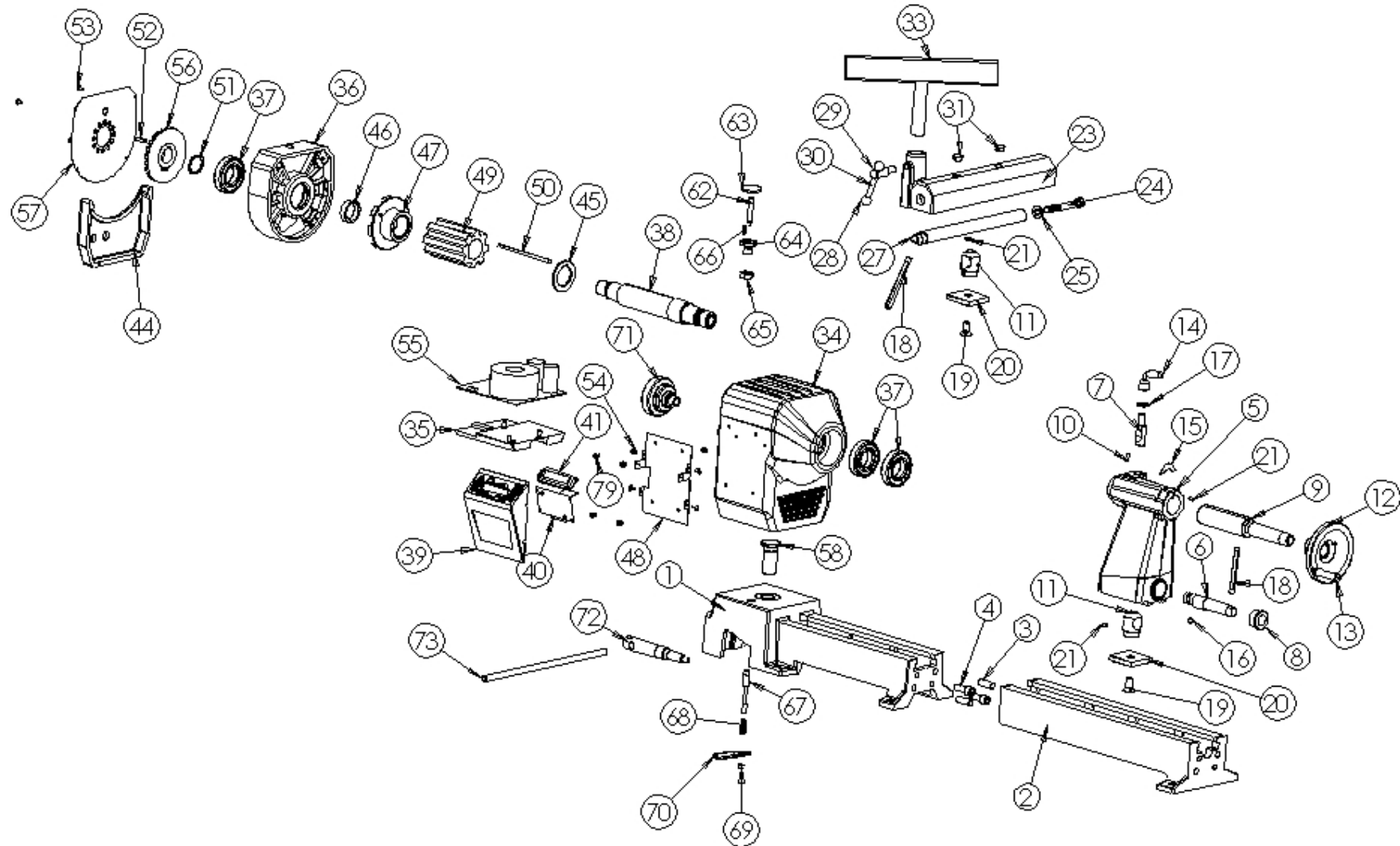



## Accessories

### Add On Bed Extension: BU3000

Extend the bed of your Nova DVR 3000 Woodlathe for greater capacity for turning between centers. Each bed unit adds 510 mm (20 in.)

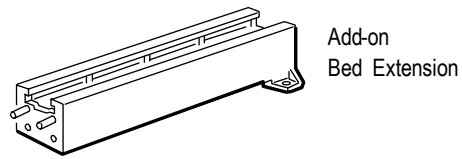

Add-on  
Bed Extension

### Lathe Stand

Strong, rigid, 4 mm thick sheet metal lathe stand, 86 cm (34 in.) high for the Nova 3000 and DVR 3000. The legs have an extra flange to allow you to insert a piece of plywood to create a boxed leg for filling with sand for even extra vibration dampening. The stand is available in two models one to fit the standard Nova 3000 and DVR 3000 and one to fit an additional add-on extension bed.

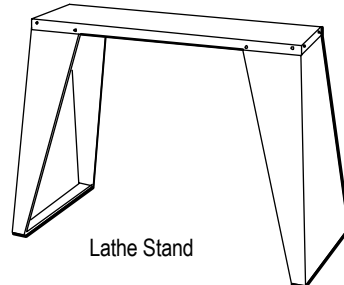

Lathe Stand

### SuperNova Chuck: SNSZ or SNCZ

A next-generation, self-centering chuck to securely hold round and square work pieces for centerless turning. The special Tuff Lock gearing delivers amazing holding power in both the contraction and expansion mode. It has an open-back for easy cleaning and can be tightened one-handed with an articulated key. It includes a screw chuck. A wide variety of optional jaws are available to hold almost any work piece.

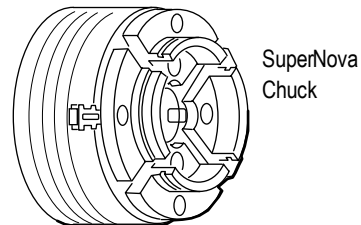

SuperNova  
Chuck

### Small Toolrest: TR100/1

A small 100 mm (4 in.) toolrest (not shown) for turning small work pieces or reaching into recessed areas.

### Bowl Toolrest: TRB/1

A curved toolrest, which gives you, better chisel support on both the outside and inside of a bowl. Because of the curve you are able to position your chisel support closer to the bowl.

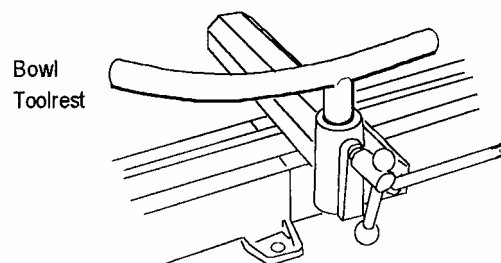

Bowl  
Toolrest

### Revolving Center System: NLCS or NLCS1

A multi-function live center system to expand your options when turning between centers. It includes quick change tapers: a hollow cup center point, threaded center, cone center, and an extension center. Made with three bearings and precision machined for a high quality finish.

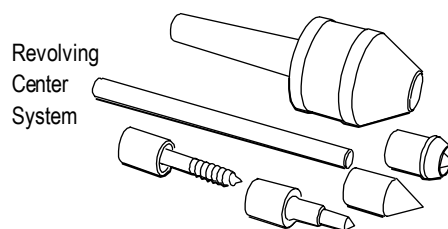

Revolving  
Center  
System

### Handwheel Unit: LHB

The handwheel is mounted on the outboard end of the headstock spindle so you can manually position work or to slow it down. The vacuum coupler can also be added to this unit to make a vacuum holding option.

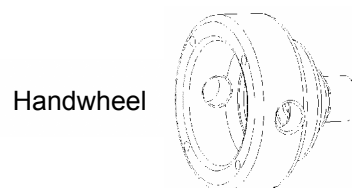

Handwheel

## Accessories

### Faceplates:

#### SFP80L (with side-locking function).

Faceplates are used to mount the work piece when faceplate turning bowls or platters.

Faceplates are available in 80 mm (3").

A vacuum faceplate is also available.

The 80mm (3") faceplate is made of solid steel. This faceplate has a small contact area to allow maximum freedom while shaping. It comes with 2 notches on the outside diameter for removing the faceplate from the spindle. This can be done with a light drift and mallet.

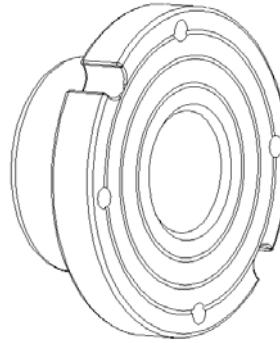

#### Vacuum Coupler: 25008

The Vacuum Coupler (not shown) fits onto the Handwheel Unit. It provides a secure attachment for your vacuum cleaner hose. For those turners who are interested in vacuum chucking, this is a simple system.

#### Outrigger Unit: OR3000

Extend the bowl turning capacity of the Nova DVR 3000 Woodlathe to up to 740 mm (29 in.) in diameter. This unit is made from cast iron, is easy to position and control, and mounts to the headstock end of the lathe.

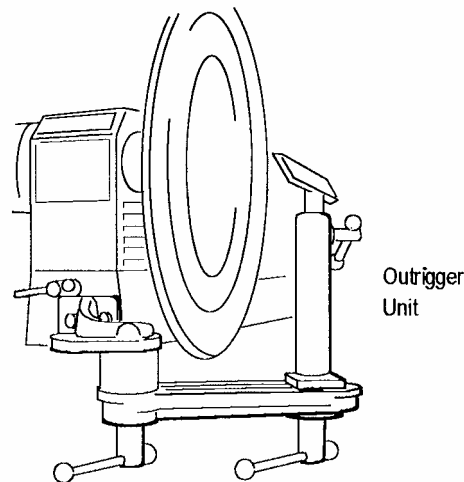

#### Nova Ornamental Turner: ORN3000\_\_

This unique and innovative accessory allows you to easily add an endless array of decoration, ornamentation and threading to your work. Precision machined, this unit is easy to position and control and mounts to the bed unit of your Nova DVR 3000 lathe. A wide range of accessories, comprehensive manual and video are also available.

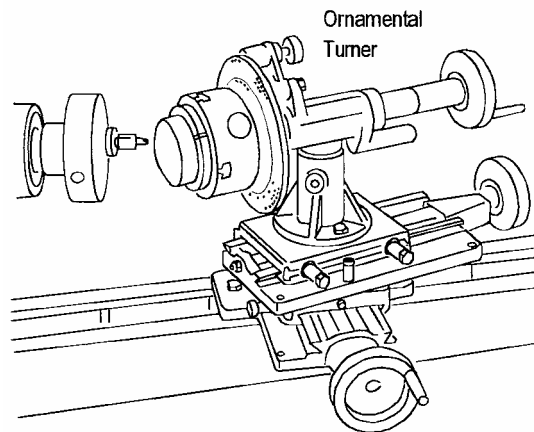

*For further details about Teknatool's lathe accessories please contact your local retailer for more information, or contact us for a free product catalogue. This catalogue can also be downloaded from our website - at [www.teknatool.com](http://www.teknatool.com).*



# Index

---

- Accessories 29, 30
- Assembling 11
- Bed - Lathe 8, 11, 26
  
- Camshaft 21
- Centerlines Turning 19
- Centers 11, 19
- Changing Speeds 15
- Chuck 18, 29
- Cleaning 22, 23
- Components 2, 7, 11
- Connecting to Power, 13
- Contents, 5
- Distance between Centers, 8
- Electrical, 6, 7, 9, 13
- Extension Bed, 12, 26, 29
- Extension Cords, 9, 13
- Faceplate, 2, 7, 8, 18, 23, 30
- Function, 15, 16, 18
- Handles, 7, 12, 19, 21
- Handwheel, 8, 22, 23, 25, 26, 29, 30
- Headstock Lockpin, 11, 17, 25
- Headstock, 2, 5, 7, 8, 9, 11, 13, 17, 18, 19, 22, 24.
- Lathe Stand Requirements, 9, 10, 13, 23, 29.
- Live Center, 8, 24, 29
- Lubrication, 22
- Maintenance, 2, 22
- Mounting Faceplate or Chuck, 18
- Mounting, Lathe, 8,15
  
- Nova DVR3000 Parts, 13
- Nova DVR3000 Specifications, 8
- Oil, 22, 24
- Operating, 6, 7,11, 17, 21
- Operating Bar, 11, 17, 14, 27
  
- Ornamental Turner, 8, 30
- Outrigger Unit, 8,13, 30
  
- Parts List, 26, 27
- Parts Nova DVR 3000, 11, 16, 25, 26
- Power, 2, 6, 7, 9, 13-17, 22, 29
- Problems, 23
  
- Quill, 7, 8, 21-25
  
- Removing Centers and Tapers, 21
- Revolving Center System, 29
- Rpm, 8, 14, 15, 23
  
- Safety, 6, 7
- Sanding, 16, 19
- Shop Requirements, 9
- Specifications, 8
- Speed, 15, 20
- Spindle Index, 8, 17, 24
- Spindle Threads,18
- Spur Center, 18, 19
- Stand, 9, 10, 13, 23, 25, 29
- Standard Equipment, 8
- SuperNova Chuck, 8, 29
- Swing, 8
- Swiveling the Headstock, 17
  
- Tailstock parts list, 27
- Tailstock, 11-13, 21-23, 25
- Teknatool, 3, 4, 5
- Toolrest Options, 29
- Toolrest, 7, 8, 11, 14, 15, 19, 23, 26
- Toolslide Parts List, 26, 27
- Troubleshooting, 23, 24, 25
- Turning between Centers, 19
- Turning Speeds, 20
- Turning, 2, 16, 21
  
- Unpacking, 11
  
- Vacuum Coupler, 29, 30
- Vibration, 2, 9, 16, 23, 29
  
- Warranty, 32
- Website, 4
- Work Diameters, 8, 19, 30
- Workshop Requirements, 9

# Teknatool Warranty

## **Teknatool Five Year Limited Warranty ( 2 year on electrical parts)**

This Teknatool product is backed by a warranty from the date of purchase. Teknatool International Ltd will repair or replace, at its expense and option, this Teknatool product which in normal use has proven to be defective in workmanship or material, provided that the customer returns the product prepaid to an authorized Teknatool service center with proof of purchase of the product within TWO YEARS and provides Teknatool with reasonable opportunity to verify the alleged defect by inspection. Furthermore, Teknatool International Ltd. extends this two-year period for three additional years, excluding labor costs and electrical parts, provided the aforementioned conditions are met. All electrical parts and electronics are covered by a TWO YEAR warranty from the date of purchase.

Teknatool will not be responsible for any asserted defect, which has resulted from normal wear, misuse, abuse, or repair or alteration made by anyone other than an authorized service facility or representative. Under no circumstances will Teknatool International Ltd. be liable for incidental, special, indirect, and consequential damages or expenses, including loss of profits or loss of operations. This warranty is Teknatool International Ltd sole warranty. There are no other warranties, whether written or verbal, whether expressed or implied by law, trade, custom, or otherwise, whether of merchantability, fitness for purpose, or otherwise, except for remedies available to customers under the Consumer Guarantees Act or other legislation.

OVERSEAS CUSTOMERS: Our Teknatool Distributors and agents will issue their own warranty to cover this product. Terms may vary from those stated above; please check with your dealer.

**i** Note: Did you know you can register your warranty with Teknatool online? Visit our website on [www.teknatool.com](http://www.teknatool.com) to register your warranty faster today! Or you can fill out the card below, cut, fold, seal and post.



## Teknatool Warranty Card

Return this card to validate your warranty, or register online at [www.teknatool.com](http://www.teknatool.com).

Name: \_\_\_\_\_

Address: \_\_\_\_\_  
\_\_\_\_\_  
\_\_\_\_\_

Email Address: \_\_\_\_\_

Teknatool Product Model \_\_\_\_\_

Serial Number (under headstock cover) \_\_\_\_\_

Date of Purchase \_\_\_\_\_

Reseller \_\_\_\_\_

Would you like to be on our mailing list and receive complimentary copies of our Teknatool Newsletter? (Personal information is kept confidential.)

Yes, by normal mail    Yes, by email    No

To help us provide services and products that are better tailored to your needs, please answer the following:

- Where did you purchase the product? (check one)  
 Local Woodturning Specialty    Manufacturer  
 Local General Woodworking    Mail-order Catalog  
 Other (specify) \_\_\_\_\_
  - Did you receive all information you required and expected?  
 Yes    No  
If no, explain: \_\_\_\_\_
  - What other products did you buy along with lathe purchase?  
 Lathe Chuck    Finishes    Power Tools  
 Lathe Chisels    Abrasives    Other Products  
 Lathe Accessories (list) \_\_\_\_\_
  - Why did you buy the Nova Lathe?  
 Features    Quality    Warranty    Store Advice  
 Price    NZ Made    Accessories    Product Support  
 Recommended    Reputation of Brand
  - Rate your woodturning and woodworking experience:  
 Beginner    Intermediate    Advanced
- Comments \_\_\_\_\_

**i** Note: To locate the serial number, look to the front of the headstock, under the control panel. The serial number is printed on the safety label sticker.

**Steps to registering your Warranty by Mail:**

1. Fill out the information on page 30, duplicate your serial number here for your future reference:

Serial Number: \_\_\_\_\_

- 2. Cut along the dotted line as indicated by the scissors icon.
- 3. Take the cut out, and fold along dotted line as shown.
- 4. Seal edges with sellotape/glue/tape etc.
- 5. Affix appropriate Postage Stamps for postage to New Zealand and post.
- 6. *Optional:* List your return address details in the event of mishandled post.



Affix  
Postage

Fold  
Here

Seal Along Edge

Post To:

**TEKNATOOL INTERNATIONAL**

**Warranty Registration**

PO Box 180034 Luckens Point

Henderson

Auckland 1008

NEW ZEALAND

Fold  
Here

Return Address:

---

---

---

---

Seal Along Edge



Nova DVR 3000 Woodlathe Manual

Publication Code: 101-0505-006

© Teknatool International 2003

